

GATE VALVES

DESCRIPTION

- 1 HANDWHEEL NUT
- 2 NAME PLATE
- 3 HANDWHEEL
- 4 YOKE SLEEVE
- 5 GLAND NUTS
- 6 GLAND FLANGE
- 7 GLAND STUDS
- 8 PACKING GLAND
- 9 B/B NUTS
- 10 PACKING
- 11 BONNET
- 12 GASKET
- 13 STEM
- 14 WEDGE
- 15 SEAT RINGS
- 16 BODY

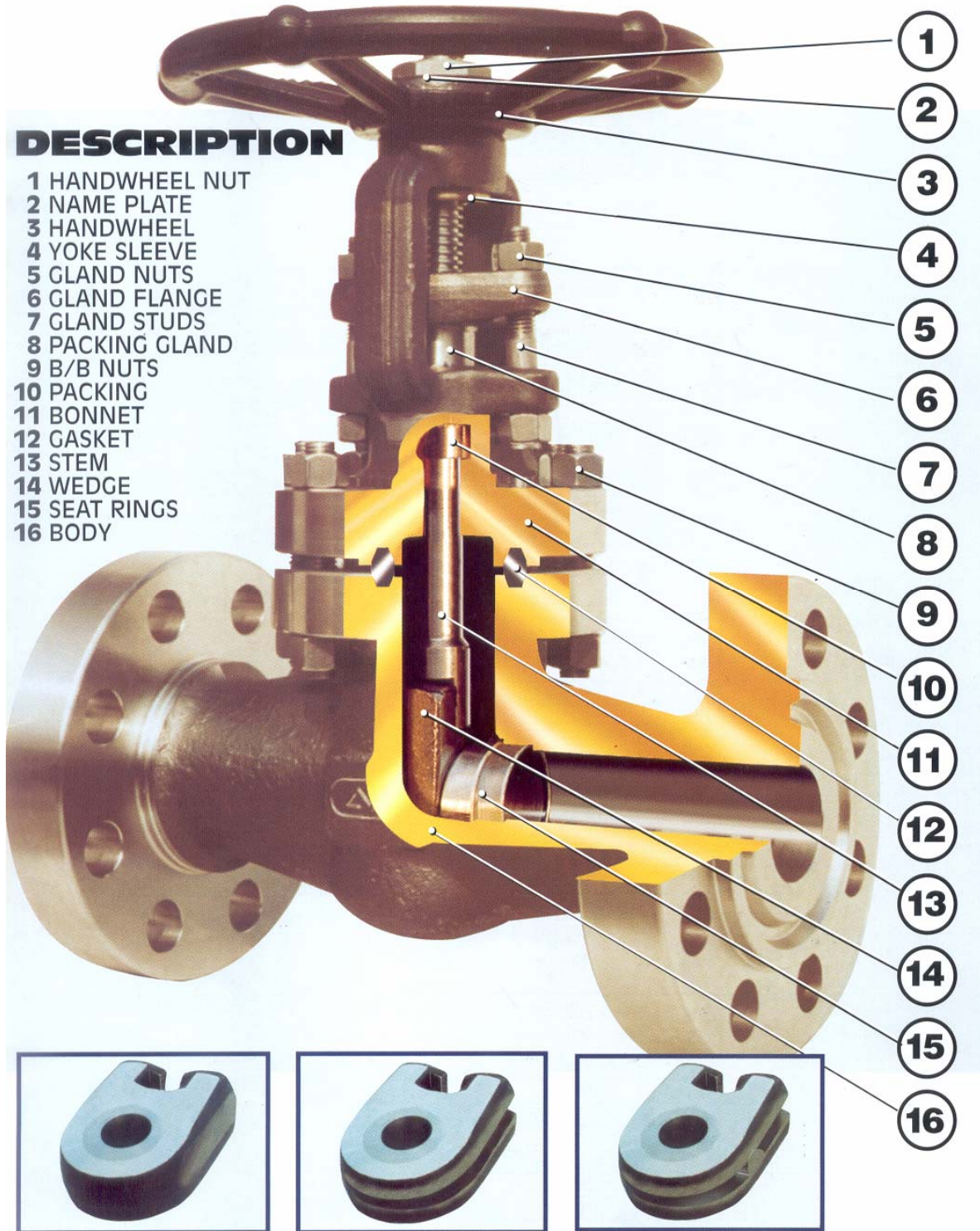

Standard wedge

Flexible wedge

Split wedge

GATE VALVES



Gate Valves 1/4" – 2"
 Socket Weld / Butt Welding / Screwed Ends
 Class 800 – 1500 – 2500 – 4500
 Outside Screw & Yoke
 Standard & Reduced Bore

Bolted Bonnet

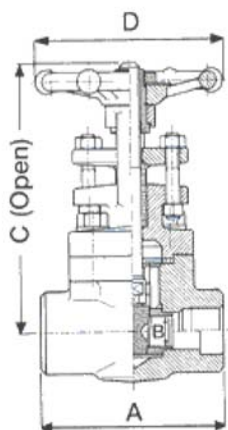

Welded Bonnet

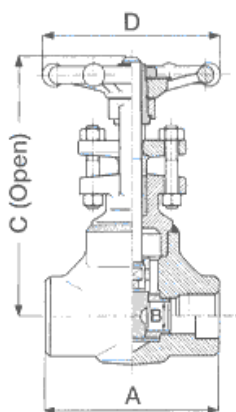

Gate Valves 1/2" – 2"
 Integral Flanged
 Class 150 – 300 – 600 – 1500 – 2500
 Outside Screw & Yoke
 Standard & Reduced Bore

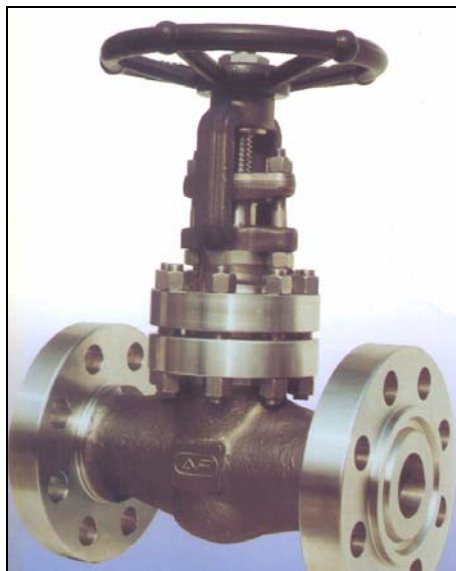
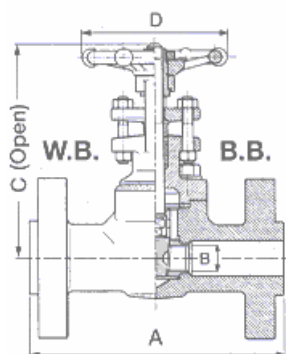

GATE VALVES



Cast Steel Gate Valves 2" – 24"

Flanged RF Ends / BW Ends

Class 150 – 300 – 600 – 900 – 1500

Yoke, Flexible Wedge and Bolted Body – Bonnet, Full Bore

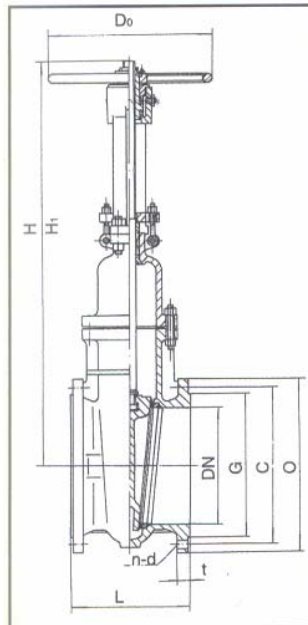
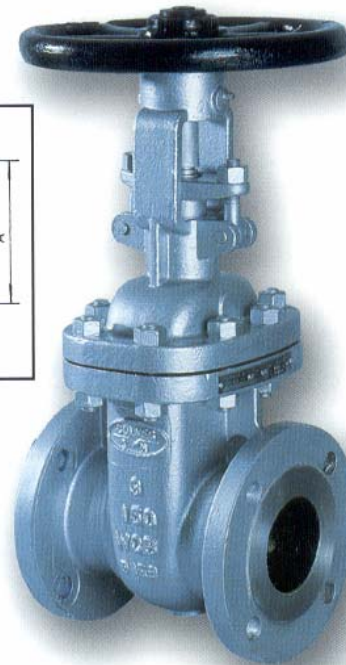
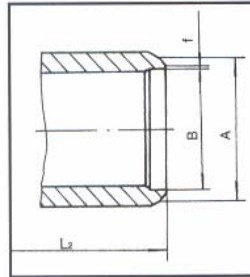
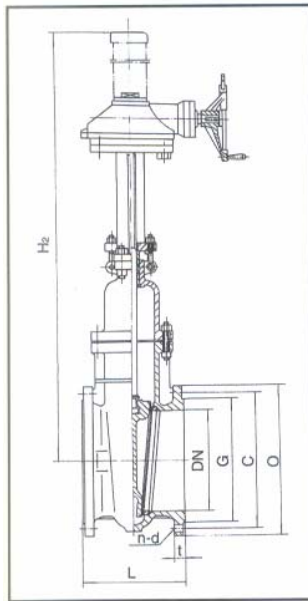

Gate Valves are Pressure Tested acc. to API 598

The Design & Material selection of the Cast Steel Gate Valves are in accordance with the American Stds ANSIB16.34 and API600

150 LBS	2" – 48"
300 LBS	2" – 36"
600 LBS	2" – 24"
900 LBS	2" – 10"
1500 LBS	2" – 6"



GLOBE VALVES

DESCRIPTION

- 1 HANDWHEEL NUT
- 2 NAME PLATE
- 3 HANDWHEEL
- 4 YOKE SLEEVE
- 5 GLAND NUTS
- 6 GLAND FLANGE
- 7 GLAND STUDS
- 8 PACKING GLAND
- 9 PACKING
- 10 B/B NUTS
- 11 BONNET
- 12 RING JOINT
- 13 STEM
- 14 DISC
- 15 SEAT RING
- 16 BODY

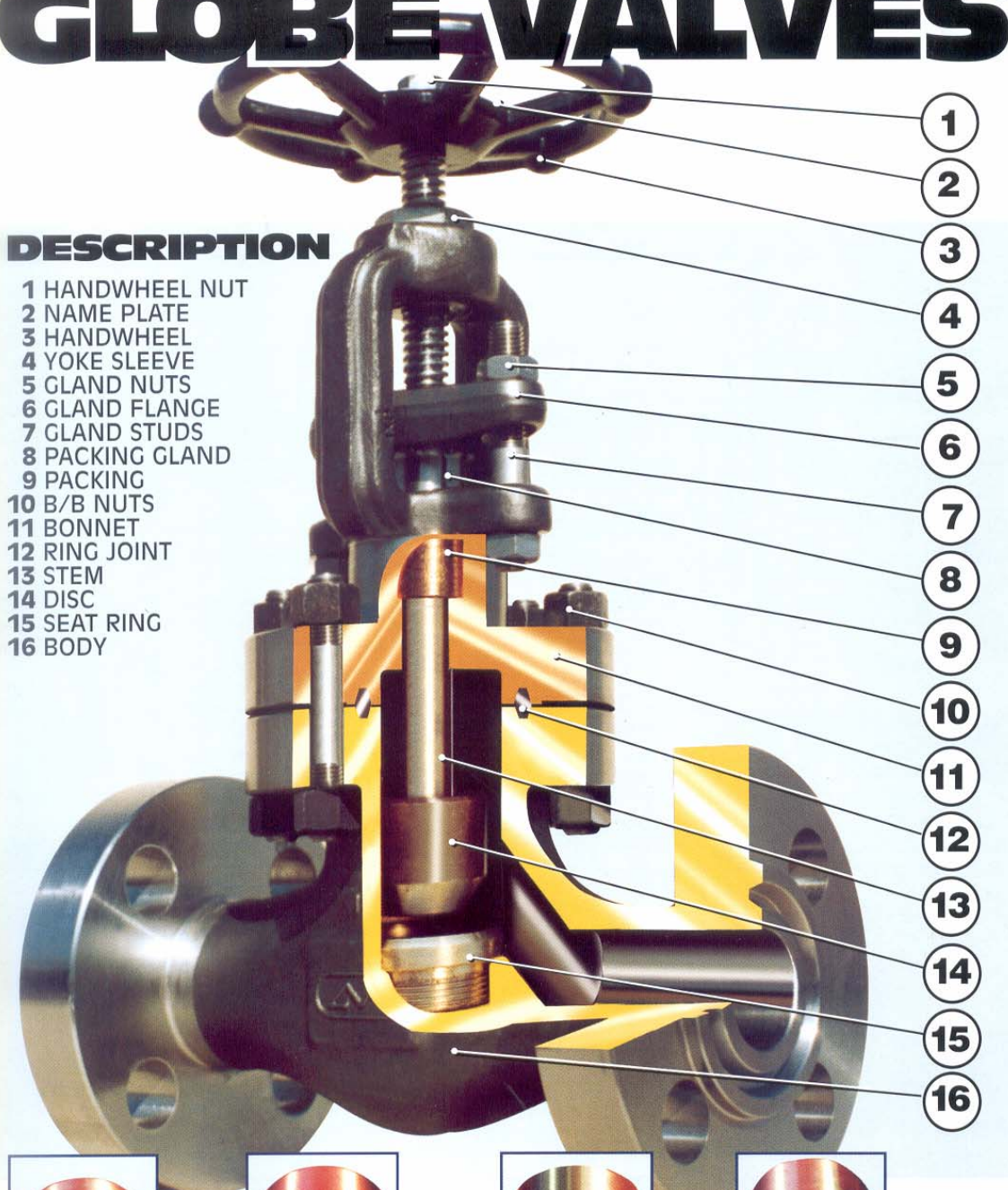

Disc type



Ball type

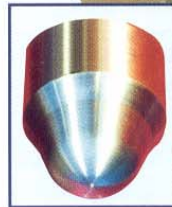

Parabolic type



Needle type

GLOBE VALVES



Globe Valves 1/4" – 2"
 Socket Weld Ends / Screwed Ends
 Class 800 – 1500 – 2500 – 4500
 Outside Screw & Yoke
 Standard & Reduced Bore

Bolted Bonnet

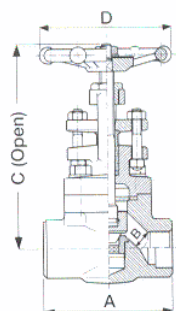

Welded Bonnet

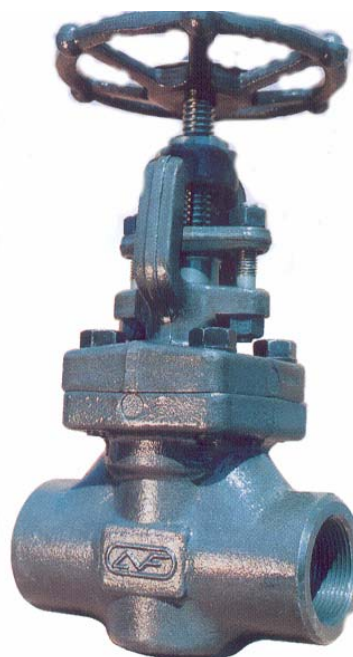
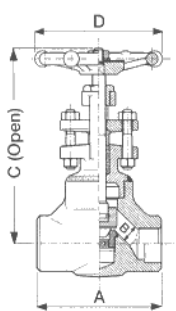

Globe Valves 1/2" – 2"
 Integral Flanged
 Class 150 – 300 – 600 – 1500 – 2500
 Outside Screw & Yoke
 Standard & Reduced Bore
 Welded & Bolted Bonnet

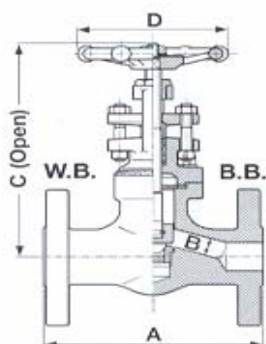

GLOBE VALVES



Cast Steel Globe Valves 2" – 18"
 Flanged RF Ends / BW Ends
 Class 150 – 300 – 600 – 900 – 1500
 Yoke, Flexible Wedge and Bolted Body – Bonnet,
 Full Bore

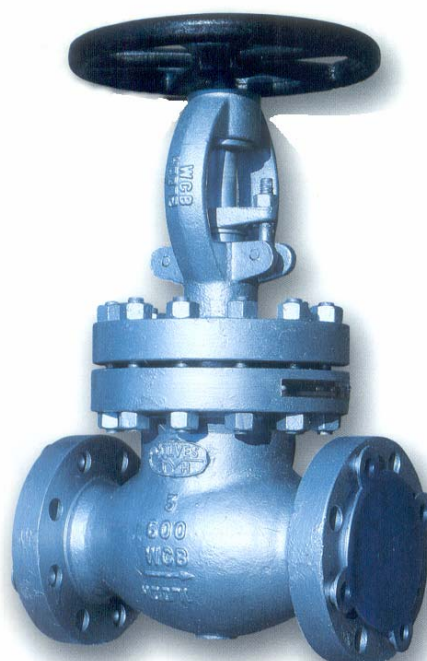
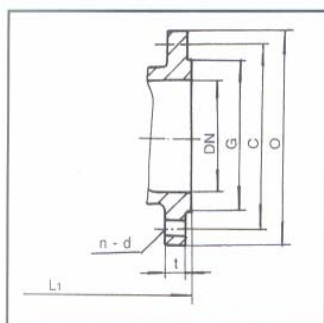
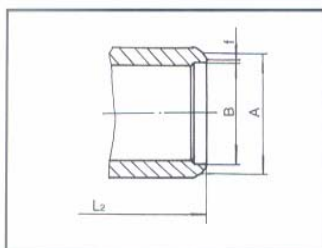
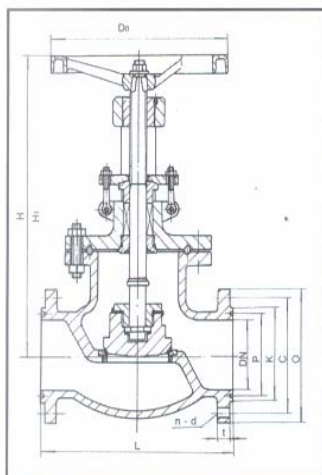

Gate Valves are Pressure Tested acc. to API 598

The Design & Material selection of the
 Cast Steel Globe Valves are in accordance with the American
 Stds ANSI B16.5

Face to Face dimensions to ANSI B16.10
 and butt-welds to B16.25

Operating parameters are acc. to ASME/ANSI B 16.34

150 LBS	2" – 18"
300 LBS	2" – 18"
600 LBS	2" – 12"
900 LBS	2" – 6"
1500 LBS	2" – 4"

CHECK VALVES

DESCRIPTION

- 1 B/B STUDS
- 2 RIVET
- 3 NAME PLATE
- 4 B/B NUTS
- 5 COVER
- 6 RING JOINT
- 7 SPRING
- 8 PISTON
- 9 SEAT
- 10 BODY

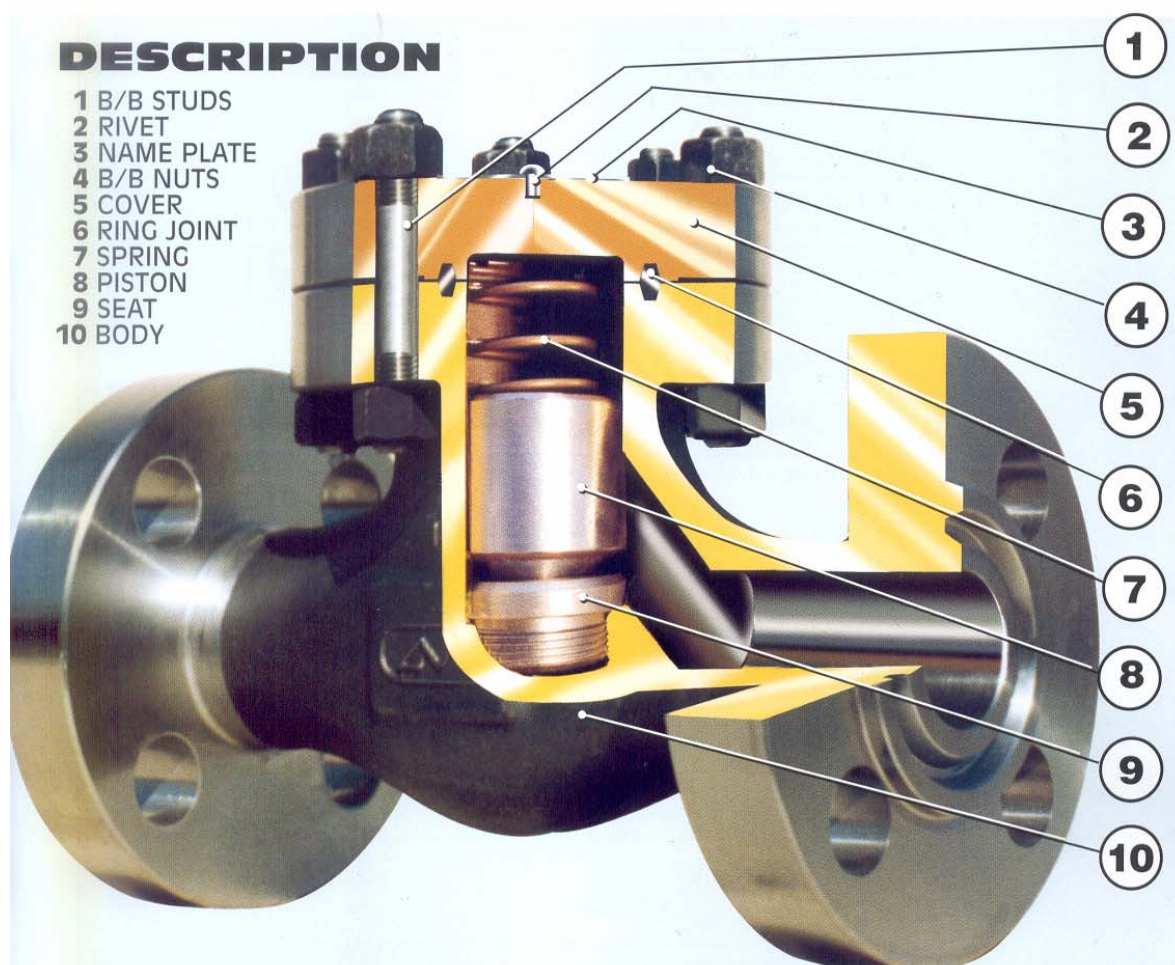

Piston type Fig. n° 300

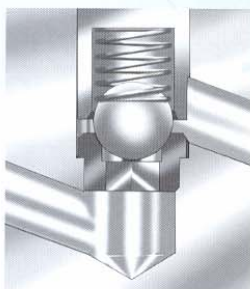

Ball type Fig. n°400

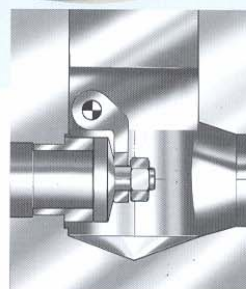

Swing type Fig. n° 500

CHECK VALVES



Check Valves 1/4" – 2"
Socket Weld Ends / Threaded Ends
Class 800 – 1500 – 2500 – 4500
Standard & Reduced Bore

Bolted Cover

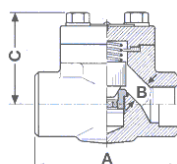

Welded Cover

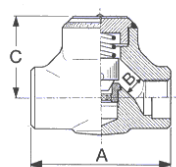

Check Valves 1/4" – 2" Y-Pattern - Piston/Ball Type
Socket Weld Ends / Threaded Ends
Class 800 – 1500 – 2500 – 4500
Standard Bore



Socket Weld in compliance
to ANSI B16.11
NPT in compliance to ANSI B1.20.1

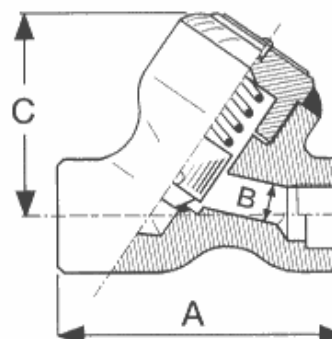

CHECK VALVES



Cast Steel Check Valves 2" – 24" Swing Type
 Flanged RF Ends / BW Ends
 Class 150 – 300 – 600 – 900 – 1500
 Acc. to API6D & ASME ANSI B16.34

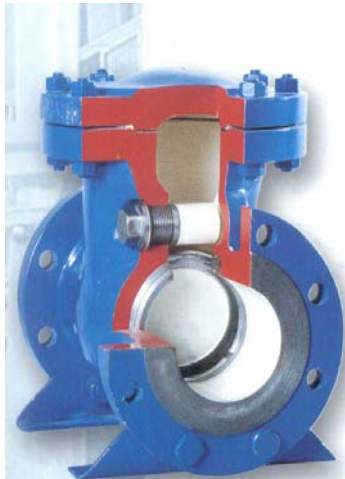

Cast Steel Swing Check valve are Pressure Tested acc. to API 6D

Face to Face dimensions to ANSI B16.10 – B16.5
 and butt-welds to B16.25

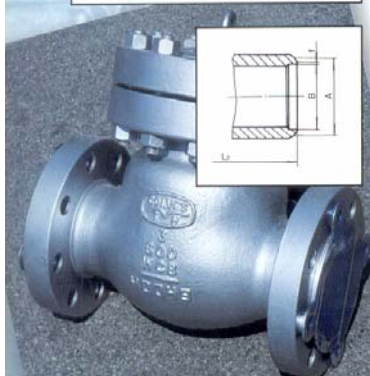
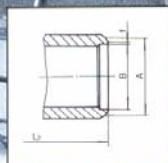
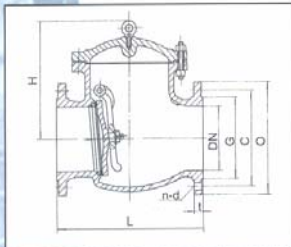

150 LBS	2" – 24"
300 LBS	2" – 20"
600 LBS	2" – 12"
900 LBS	2" – 10"
1500 LBS	2" – 4"